



9 Wandeeet Place SANDY BAY, TAS



RETRO CLASSIC WITH VIEWS

Commanding panoramic river views of The River Derwent and bathed in all day sunshine, 9 Wandeeet Place is nestled amongst some of Sandy Bay's most prestigious property and will appeal to both the astute owner occupier and investor. Positioned with a bright north-easterly aspect, this solidly built 4 bedroom brick home has been in the same family since it was built in the late 1950s.

Warwick Page

Director & Real Estate Agent

0474122717



Approx Floor Area 148 Sqm
(Including Laundry)

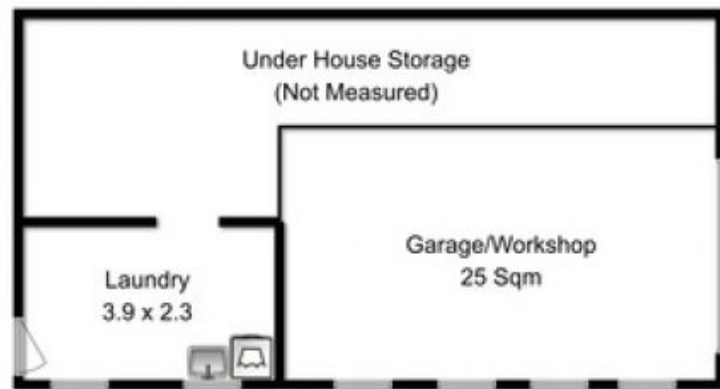

Fixtures & Fittings are for display only, not to scale.
Produced by Open2view.com

