



440 Nelson Road MOUNT NELSON, TAS



## SOLD

Captivating views of the Derwent River are the star of this warm and versatile four-bedroom home, well located on the upper bends of Mount Nelson.

Filled with natural light and freshly painted in neutral tones, it offers several winning features, including sealed access and extra parking off Olinda Grove, ground floor alternate front door entry, huge workshop and storage, undercover outdoor area and native gardens.

Downstairs can be accessed internally or via the separate ground floor entry. This space has plenty of potential, either as a fourth bedroom or home office, teenage retreat or additional living area. A useful entry area/study with under-the-stairs storage leads to the g

### Mel Shutt

Director and Property  
Consultant  
0428428884

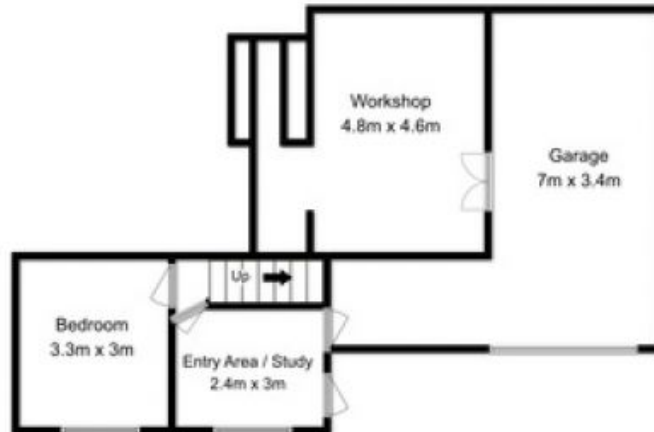
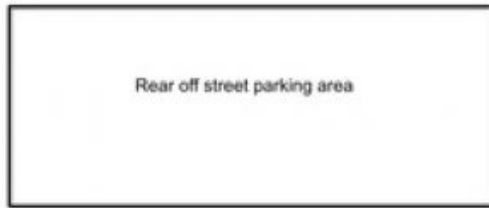

Floor Area approx: 184sqm



Fixtures and fittings are for display only, not to scale.  
 This floor plan is a sketch for illustration only.  
 All measurements are internal and approximate.  
 Produced by open2view.com for Ripple Realty