



13 Timbertop Drive BLACKMANS BAY, TAS



4



2



2

## SPACIOUS FAMILY HOME WITH VIEWS

Perfectly positioned to capture magnificent river views, with a north east aspect attracting all day sun, this superbly presented 4 bedroom brick home offers a contemporary floor plan with multiple living options in a highly regarded pocket of Blackmans Bay. Filled with an abundance of natural light and spacious open living the property would make a fabulous family home or investment.

Within close proximity to Kingston shopping centre, local schools and a 15 minute drive to Hobart CBD, this exclusive family residence is certain to leave a lasting impression upon inspection.

"We have obtained all information in this document from sources we believe to be reliable; however, we cannot guarantee its accuracy. Prospective purchasers are advised to carry o

**Warwick Page**

Director & Real Estate Agent

0474122717

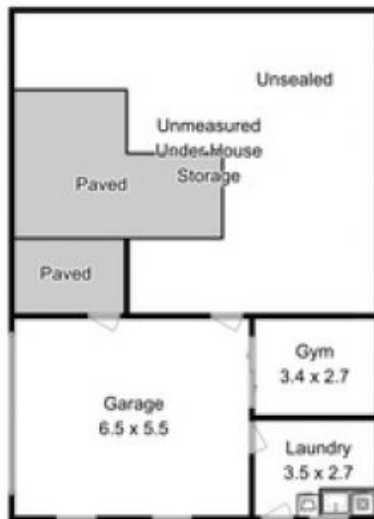

Approx First Floor Area  
(unmeasured area not included): 58.2 Sqm



Approx First Floor Area: 202 Sqm

Fixtures and Fittings are for display only and not to scale.

This floor plan is a sketch for illustration.

All measurements are internal and approximate.

Produced by open2view.com