



3/4 Myella Drive BERRIEDALE, TAS

 1
  1
  1

Stylishly renovated apartment

Contemporary and completely refreshed throughout, here is a stylish and functional one-bedroom apartment ideal for first home buyers and professionals searching for low-maintenance living with the convenience of the area's many amenities so close by, or investors looking to enhance their portfolio with a rental appraisal of \$350-\$360 per week.

Council Rates: \$1,220.00/year (approx)

There's an inviting open plan area that includes a light-filled and comfortable living space, room for dining, and an updated kitchen with plenty of storage space and new appliances (including a dishwasher).

One parking space is available at the front of the complex, which is handy for the 15-minute drive into Hobart's CBD or 5km journey to Northgate Shopping Centre in Glenorchy. A bus service is just around the corner, and the Intercity Cycleway is around 200m away - perfe

Warwick Page

Director & Real Estate Agent

0474122717

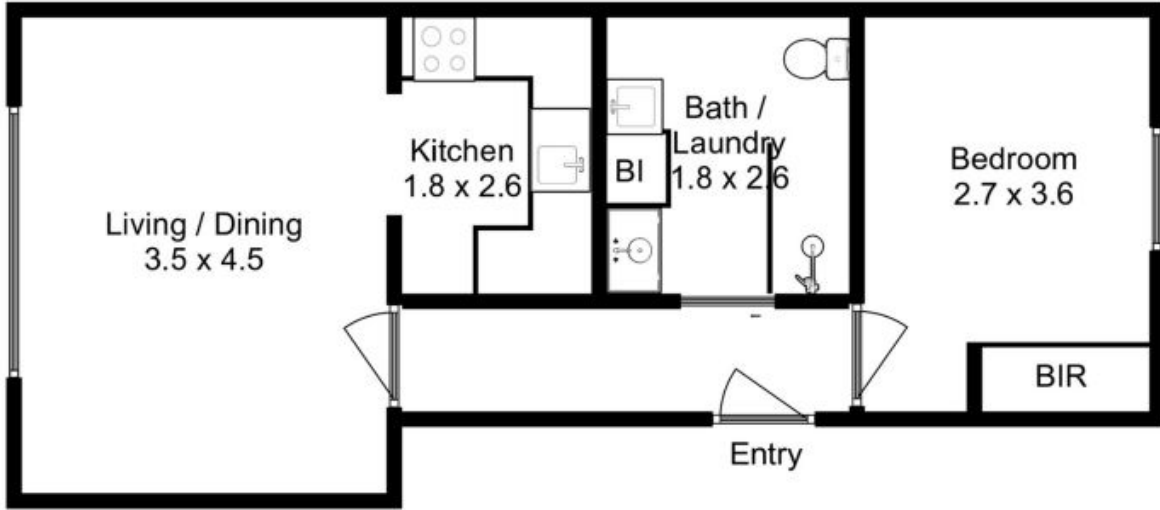

All measurements are internal and approximate.
This plan is a sketch for illustration, not valuation.
Produced by Open2view.com for Ripple.

Approx. floor area : 48 sqm

